

**Flewelling & Moody**  
 Headquarters Office:  
 766 Colorado Boulevard  
 Los Angeles, California 90041-1175  
 213 251-4151 FAX 213 258-7512  
 E-Mail: flewmoody@earthlink.net  
 Antelope Valley Office:  
 1035 West Lancaster Boulevard  
 Lancaster, California 93534  
 805 946-0771 FAX 805 946-2845  
 E-Mail: flewmoody@earthlink.net

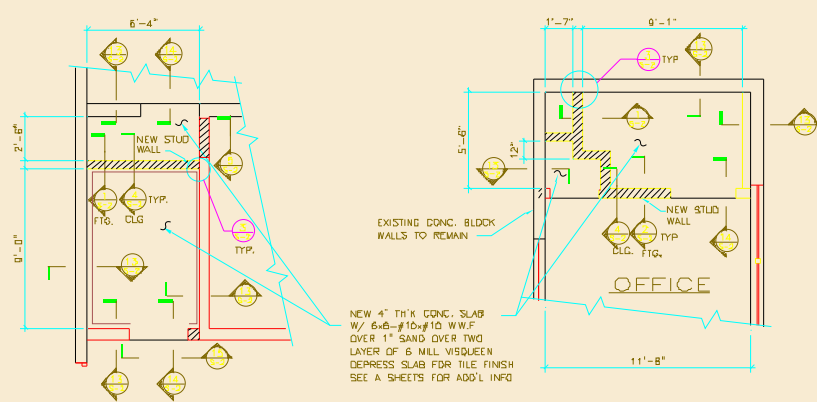

PART FLOOR PLAN BUILDING NO 1

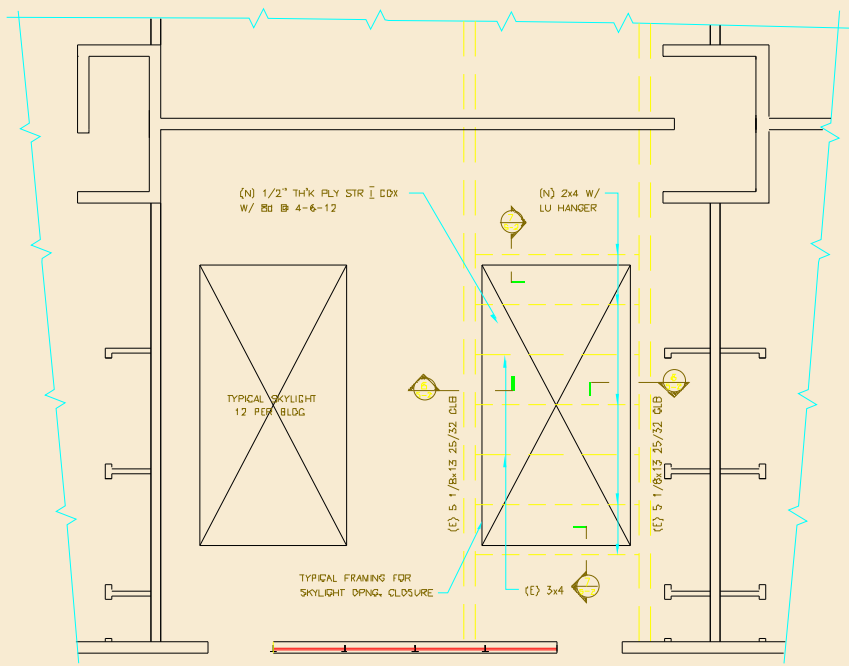

PART ROOF FRAMING PLAN AT BUILDING NO 2, 3 & 4

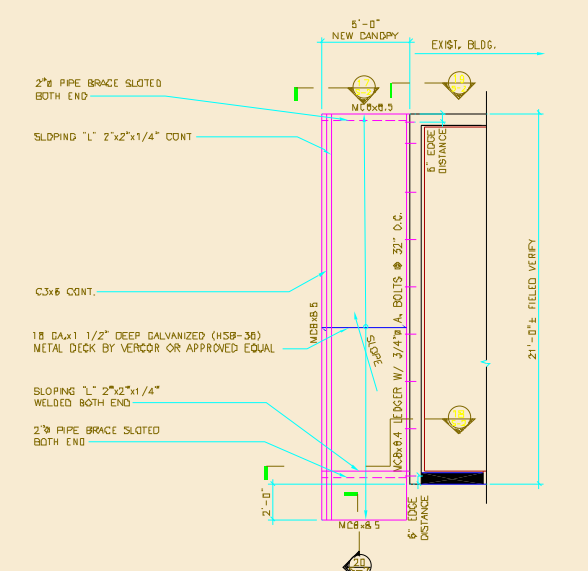

NEW CANOPY FRAMING PLAN - BUILDING NO 5

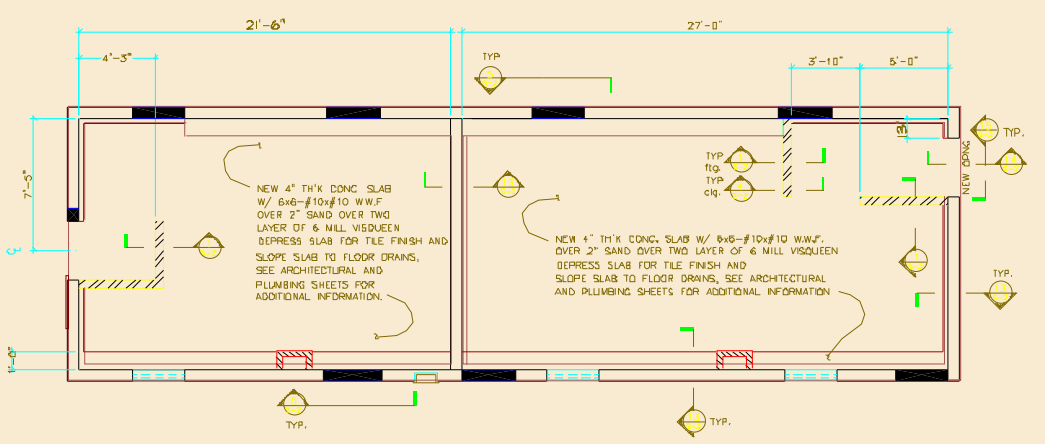

BUILDING NO 6 FLOOR PLAN

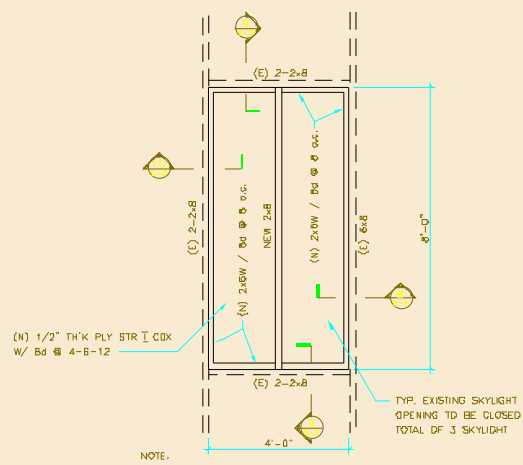

PART ROOF FRAMING OF BUILDING NO 5 & 6

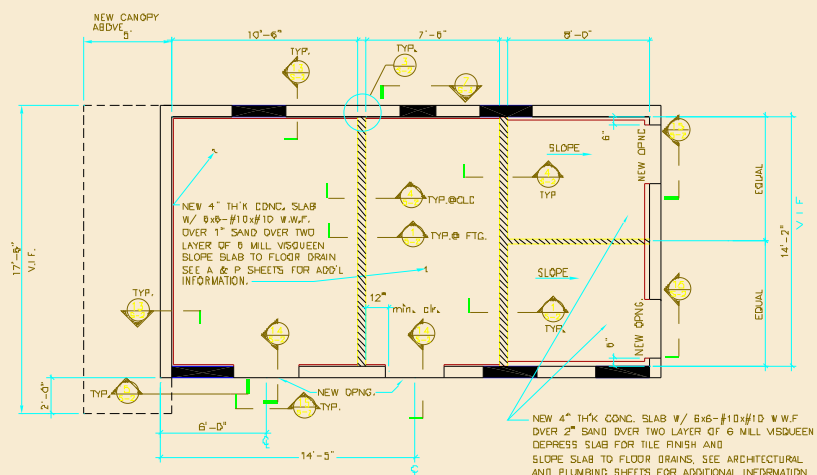

BUILDING NO 5 FLOOR PLAN

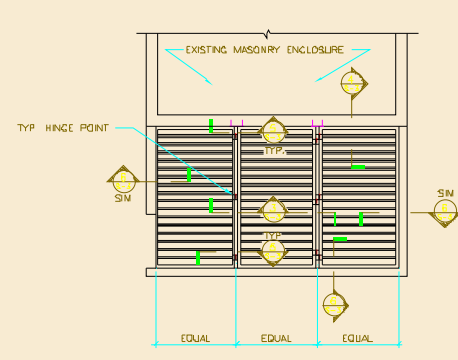

HEAT PUMP ENCLOSURE SECURITY COVER PLAN

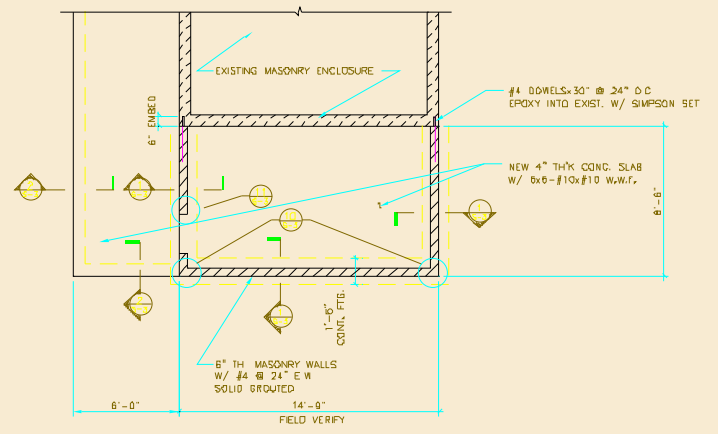

HEAT PUMP ENCLOSURE FOUNDATION PLAN

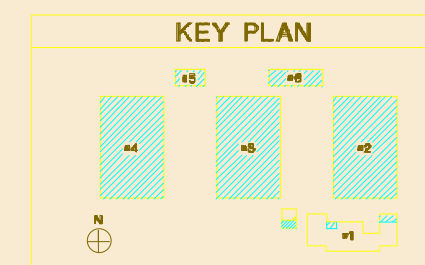

KEY PLAN

Consultants:  
**Bahman Ehsan Inc.**  
 Consulting Structural Engineers  
 4380 CRENSHAW BLVD. SUITE 400  
 VAN NUYS, CA 91411  
 PHONE (818) 461-2218  
 FAX (818) 461-2218

Drawn by: D.K.  
 Checked by: B.C.

Revisions

No.	Date	Description

All dimensions must be checked at the site by the contractor who accepts full responsibility for their accuracy under the contract. These plans & the application for construction permit have been prepared for the works and they are not responsible for their use in whole or in part or any other use & hereby disclaimed by drawing & notes.

WISBURN SCHOOL DISTRICT  
 HAWTHORNE, CALIFORNIA  
 PETER BURNETT SCHOOL  
 MODERNIZATION PHASE II  
 Pupil and Staff Toilet  
 Room Renovation

PART FLOOR PLANS AND ROOF FRAMING PLAN FOR BLDG #1, 2, 3, 4, 5 & 6, CANOPY & ENCLOSURE PL.

Job No. 1566.00  
 0006  
 Date 05-27-04  
 S-1  
 OF 3 SHEETS